

The high thermal output and much reduced protrusion of the round tubes with curved

corners are the main characteristics of the MAHN heated towel rail. The beauty of

radiators using thin tubes is highlighted by the absence of sharp corners.

## DIMENSIONS

Width 28/50/60/75 cm

Height 68,3/89,3/116,8/144,3/177,3 cm

Depth 6,5 cm

Depth from wall 9,5 cm

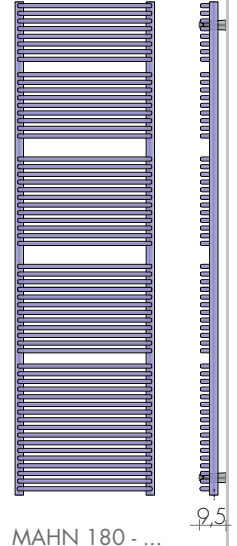
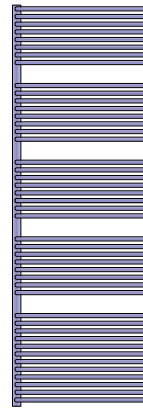
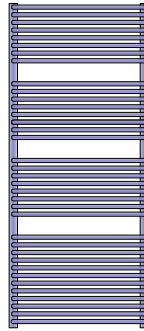
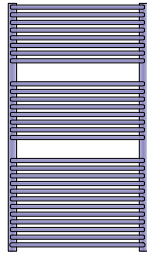
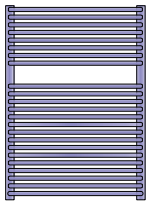

MAHN 70 - 50

MAHN 90 - ...

MAHN 120 - ...

MAHN 150 - ...

MAHN 180 - ...

MODEL	HxL cm	white sablé standard €	EN 442		▲▽ t.c. cm	Height H cm	Width L cm	Weight M Kg	Volume V dm <sup>3</sup>	MIXED Version*(EHE cl.II) with:		
			Δt 50 K watt	Δt 30 K watt						cable <sup>o</sup> €	digital thermostat W	digital thermostat €
MAHN	70-50	483,60	420	220	47	68,3	50	5,5	3,31	89,90	400	150,20
MAHN	90-50	615,00	549	287	47	89,3	50	7	4,22	91,80	500	152,20
MAHN	90-60	639,10	636	333	57	89,3	60	7,9	4,59	93,70	650	160,20
MAHN	120-50	731,70	684	358	47	116,8	50	9	5,47	93,70	650	160,20
MAHN	120-60	762,90	814	426	57	116,8	60	10,2	5,95	97,90	800	163,30
Slim-MAHN	150-28	791,40	541	283	25	144,3	28	7,5	5,21	91,80	500	152,20
MAHN	150-50	867,30	833	436	47	144,3	50	11	6,73	97,90	800	160,20
MAHN	150-60	909,30	986	516	57	144,3	60	12,6	7,31	101,00	900	163,30
Slim-MAHN	180-28	940,20	683	357	25	177,3	28	9,7	6,76	93,70	650	160,20
MAHN	180-50	1025,80	1056	552	47	177,3	50	13,9	8,40	-	-	-
MAHN	180-60	1078,40	1226	641	57	177,3	60	15,8	9,14	108,30	1200	170,60
MAHN	180-75	1166,50	1562	817	72	177,3	75	18,7	10,25	117,70	1500	180,00
MAHN-PLUS	150-50	1488,80	1604	842	47	144,3	50	20,5	13,20	117,70	1500	180,00
MAHN-PLUS	180-50	1735,60	2011	1056	47	177,3	50	26,8	16,46	-	-	-
CHROME-PLATED VERSION												
M-CROM	70-50	975,60	336	176	47	68,3	50	5,5	3,31	-	-	-
M-CROM	90-50	1243,50	439	229	47	89,3	50	7	4,22	89,90	400	152,20
M-CROM	120-50	1478,40	547	286	47	116,8	50	9	5,47	91,80	500	154,10
M-CROM	150-28	1598,20	433	227	25	144,3	28	7,4	5,21	89,90	400	152,20
M-CROM	150-50	1752,00	666	349	47	144,3	50	11	6,73	93,70	650	160,20
M-CROM	180-28	1895,00	546	285	25	177,3	28	9,7	6,76	91,80	500	154,10
M-CROM	180-50	2072,40	845	442	47	177,3	50	13,9	8,40	97,90	800	160,20
M-CROM	180-60	2694,90	980	512	57	177,3	60	15,8	9,14	101,00	900	163,30

Δt 40K = Watt Δt 50Kx0,755

\*TR accessory or mixed valve

<sup>o</sup>Radio frequency chronothermostat p.227

MAXIMUM OPERATING PRESSURE 8 BAR

## STANDARD PRODUCTION

White "sablé" paintwork - white M8B brackets  
 Chrome plated finish with chrome-pl. brackets  
 Air vent ø 1/8" - Tolerance ± 3mm

## PRODUCTION ON REQUEST

Paintwork to Brem color list with  
 chrome-plated M8C brackets +15/25%  
 Electrical version e.Mahn, page 265

## STANDARD FITTING

EG ø 1/2"  
 Fittings on request, page 287  
 Accessories, page 283



**TAPPING CENTRES**

EG vertical standard fittings  
Side fittings, on request

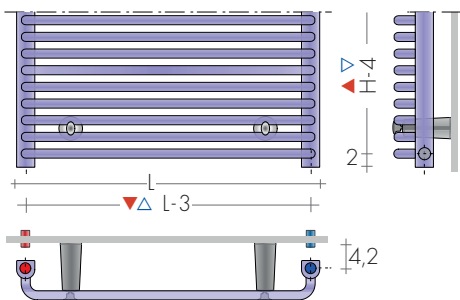

Side fittings (▲▽: H-4cm) Art. AS 75,50€

MAHN PLUS EG fittings ø 1/2"

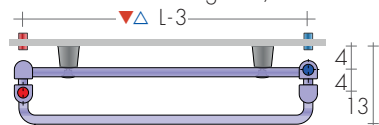

left front delivery, right rear return

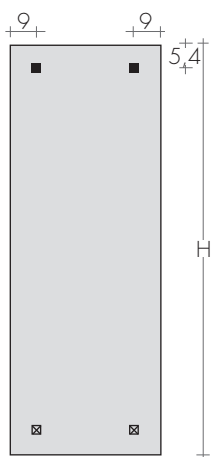

**FIXINGS**  
Brackets included



Art. M8..

MAHN h 180 cm



**RECOMMENDED VALVES**

**CHROME PLATED VALVES KIT WITH:**

- n°2 Valves with O-ring Tangs
- n°2 Fittings (multilayer ø16, copper ø12,14)
- n°2 Round washers

On request: Polished stainless tube cover  
(to be cut to right size) Art. CA18 10,80€

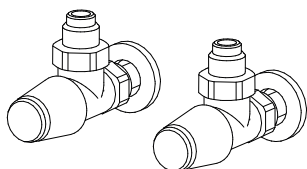

ANGLED TON VALVES KIT  
page 277

Art. KVS 119,20€

ANGLED MINI VALVES KIT page 278  
chrome-plated or white color Art. KMS 107,80€

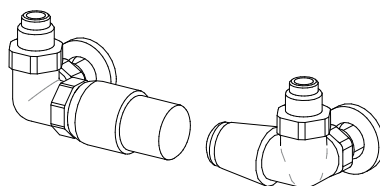

SIDE control TON VALVES KIT with  
THERMOSTATIC head Art. KTL 177,10€

SIDE control TON VALVES KIT  
page 277 Art. KVL 130,90€

REMOTE FITTINGS Art.REM 36,60€  
remote fittings at the rear (EG tapping centres)



REMOTE VALVES ASSEMBLY KIT p. 281 with:  
- n°2 Fittings (multilayer ø16, copper ø12,14)

REMOTE TON VALVES ASSEMBLY KIT  
Art. KVG 153,60€

REMOTE TON VALVES ASSEMBLY KIT with  
THERMOSTATIC head Art. KVGt 199,80€



2,5±