

design Luigi Brembilla

A striking heated radiator, from the essential lines with a thin panel (just 2.3 cm thick)

with a practical double towel rails open on three sides.

On request, the towel rails can be painted in a BREM different colour from the plate.

DIMENSIONS

Widths: 36 / 45 / 54 cm
 Heights: 80 / 130 / 180 cm
 Depth: 9,5 cm
 Depth: from wall 12,8 cm

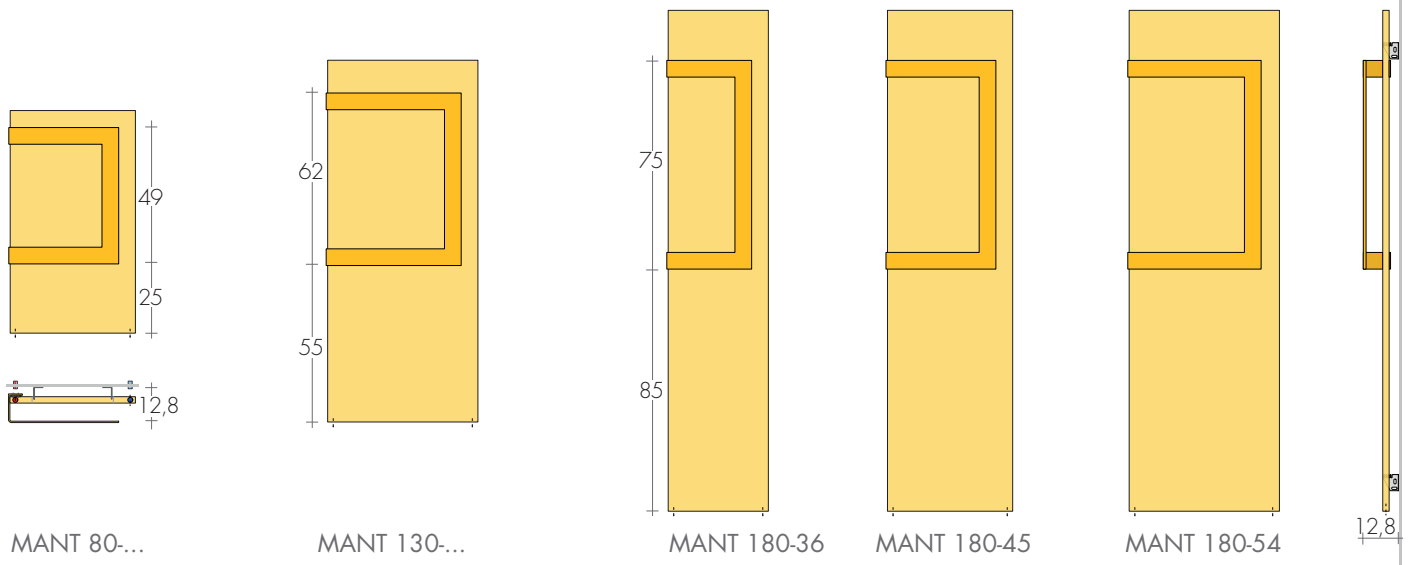

MANT 80-...

MANT 130-...

MANT 180-36

MANT 180-45

MANT 180-54

12,8

MODEL	H-L cm	white sablé standard €	EN 442		▲▼ t.c. cm	Height H cm	Width L cm	Weight M Kg	Volume V dm ³	MIXED Version* (d.II E.H.E.) with:		
			Δt 50 K watt	Δt 30 K watt						cable ^o €	W	digital thermostat €
MANT	80-45	714,40	399	210	41	80	45	11,3	3,8	89,90	400	152,20
MANT	80-54	778,80	478	251	50	80	54	13,5	4,4	91,80	500	154,10
MANT	130-45	855,10	643	338	41	130	45	18,2	6,0	93,70	650	156,00
MANT	130-54	928,50	770	405	50	130	54	21,8	6,8	97,90	800	160,20
MANT	180-36	911,00	714	376	32	180	36	20,3	7,0	93,70	650	156,00
MANT	180-45	995,70	887	466	41	180	45	25,1	8,1	101,00	900	163,30
MANT	180-54	1078,00	1061	558	50	180	54	30,0	9,2	101,00	900	163,30
MANT-L	180-45	1201,10	1181	621	41	180	45	34,4	8,1	108,30	1200	170,60

On request the bar on the right

Ready in stock

Δt 40K = W Δt 50K x 0,755

*TR accessory or mixed valve
^oRadio frequency chronothermostat p.227

TOWEL BAR MANT: STANDARD COLORS

- white sablé SB 9016
- quartz grey SB 7039
- jet black SB 9005
- same color ordered with the radiator

In one paintwork to Brem color list different from the radiator extra 35,80€



Fitting ø 3/8"
STANDARD
(without sleeves)



Fitting ø 1/2"
ON REQUEST
(with sleeves)

STANDARD PRODUCTION

White "sablé" paintwork - white EOS brackets
 Tolerance ± 3mm - Air vent ø 1/8"
 MAXIMUM OPERATING PRESSURE 4 BAR

PRODUCTION ON REQUEST

Paintwork to BREM color list with colored brackets +15/25%
 Electric version e.Mant, page 235

STANDARD FITTING

EG ø 3/8"
 Fittings ø 1/2" on request
 Special fittings, page 287



TAPPING CENTRES

EG vertical fittings as standard

Side fittings on request

Art. AS 75,50€

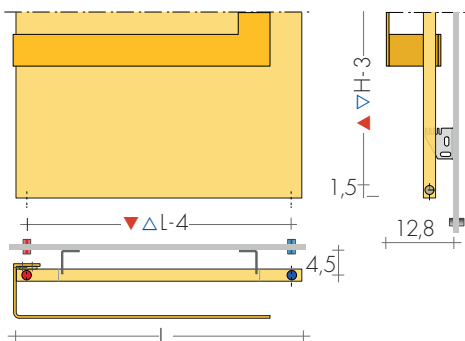

TOWEL BAR MANT

L: 30,5 - 39,5 - 48,5 cm

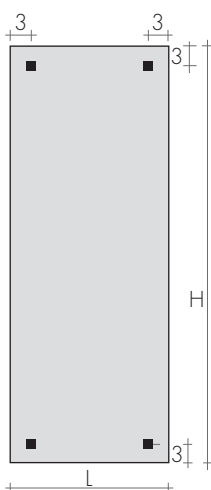

FIXINGS
Brackets included



B35 bracket



MANT 130-54

RECOMMENDED VALVES

CHROME PLATED VALVES KIT WITH:

- n°2 Valves with O-ring Tangs
- n°2 Fittings (multilayer ø16, copper ø12,14)
- n°2 Round washers

On request: Polished stainless tube cover

(to be cut to right size) Art. CA18 10,80€

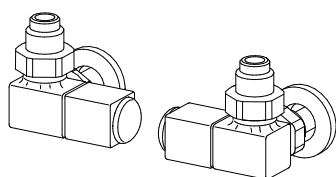

SIDE CONTROL QUADRA VALVE KIT

page 279

Art. KQL

166,30€

COLORED QUADRA VALVES

page 279

ANGLED MINI VALVES KIT

page 278

chrome-plated or white color Art. KMS107,80€

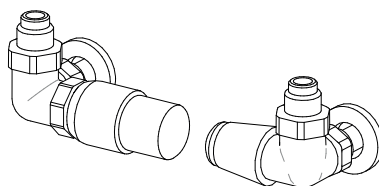

SIDE CONTROL TON VALVES KIT with THERMOSTATIC head

Art. KTL 177,10€

SIDE CONTROL TON VALVES KIT

page 277

Art. KVL 130,90€

REMOTE FITTINGS

Art. REM 36,60€

at the rear ▲▼ L-5cm

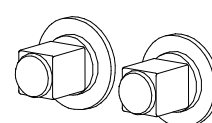

2,5 ±



REMOTE VALVES ASSEMBLY KIT p. 281 with:
- n°2 Fittings (multilayer ø16, copper ø12,14)

REMOTE QUADRA VALVES ASSEMBLY KIT

Art. KQG 167,70€

REMOTE TON VALVES ASSEMBLY KIT with

THERMOSTATIC head Art. KVT 199,80€