

design Luigi Brembilla

A striking heated radiator, from the essential lines with a thin panel (just 2.3 cm thick)

with a practical double towel rails open on three sides.

On request, the towel rails can be painted in a BREM different colour from the plate.

DIMENSIONS

Widths: 36 / 45 / 54 cm
 Heights: 80 / 130 / 180 cm
 Depth: 9,5 cm
 Depth: from wall 12,8 cm

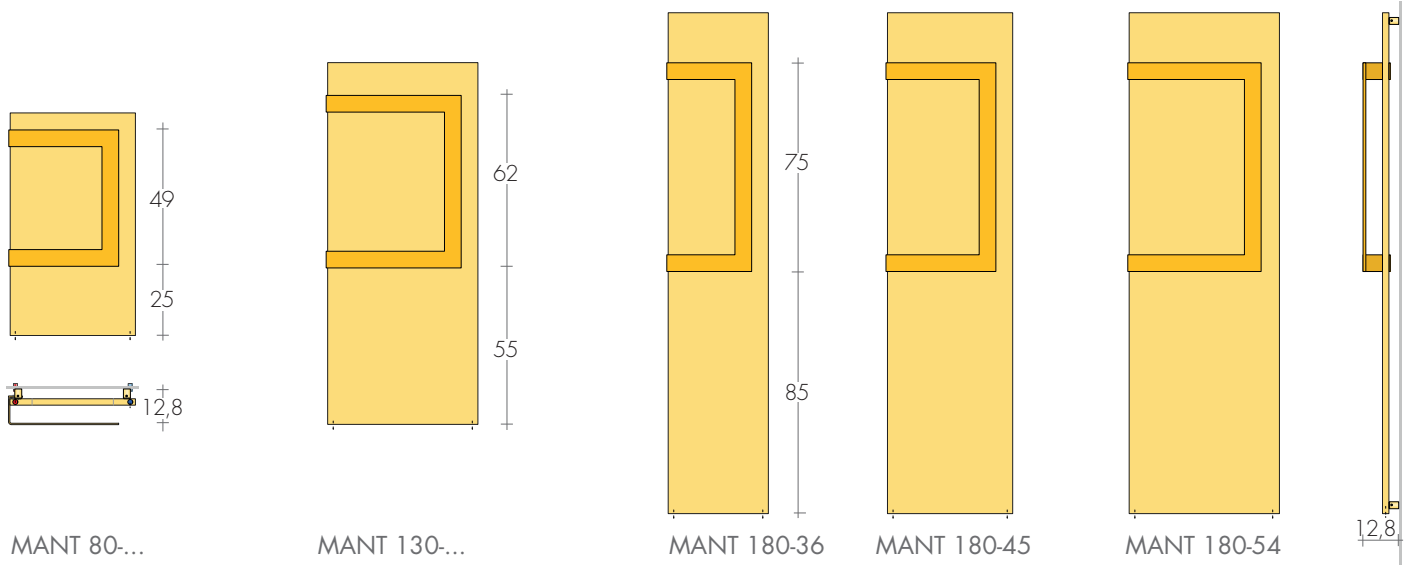

MANT 80-...

MANT 130-...

MANT 180-36

MANT 180-45

MANT 180-54

12,8

MODEL	H/L cm	Standard white sablé SB9016 €	Δt 50K watt	EN 442 Δt 40K watt	Δt 30K watt	▲ ▼ t.c. cm	Height H cm	Width L cm	Weight M Kg	Volume V dm ³	DUAL FUEL VERSION with E.H.E. and* Watt €	
MANT	80-45	862,70	399	302	210	41	80	45	11,3	3,8	400	103,40
MANT	80-54	940,50	478	362	251	50	80	54	13,5	4,4	500	105,60
MANT	130-45	1032,50	643	487	338	41	130	45	18,2	6,0	650	107,80
MANT	130-54	1121,20	770	583	405	50	130	54	21,8	6,8	800	112,60
MANT	180-36	1100,10	714	540	376	32	180	36	20,3	7,0	650	107,80
MANT	180-45	1202,30	887	671	466	41	180	45	25,1	8,1	900	116,20
MANT	180-54	1301,70	1061	803	558	50	180	54	30,0	9,2	900	116,20
MANT-L	180-45	1450,40	1181	894	621	41	180	45	34,4	8,1	1200	124,50

On request, free of charge, the bar on the right

*Dual fuel valve or T to be added p.207
 Thermostats p.208-209

TOWEL BAR MANT: STANDARD COLORS

- white sablé SB 9016 - quartz grey SB 7039
- black sablé SB 9005 - same color as the radiator

In one paintwork to Brem color list different from the radiator
 extra 52,90€

STANDARD PRODUCTION

White sablé SB9016 paintwork, B15 brackets
 Tolerance \pm 3mm - Air vent \varnothing 1/8"
 MAXIMUM OPERATING PRESSURE 4 BAR

PRODUCTION ON REQUEST

Paintwork to BREM color list with colored brackets +15/25%
 Electric version e.Mant, page 246

STANDARD FITTING

EG \varnothing 3/8"
 Fittings \varnothing 1/2" on request
 Special fittings, page 279

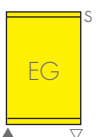

TAPPING CENTRES

Side fittings on request \varnothing 3/8" or \varnothing 1/2"
Extra Art. AS 91,20€

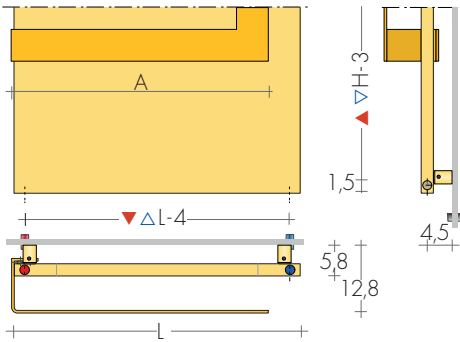

TOWEL BAR MANT WIDTH
L36 A 30,5 - L45 A 39,5 - L54 A 48,5 cm



Fitting \varnothing 3/8"
STANDARD
(without sleeves)



Fitting \varnothing 1/2"
ON REQUEST
(with sleeves)

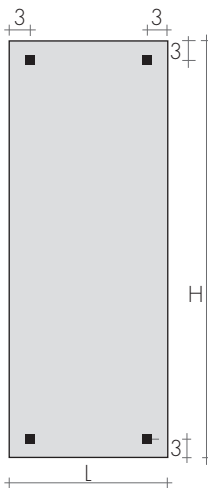

FIXINGS
Brackets included



B35 bracket



MANT 130-54

RECOMMENDED VALVES

CHROME VALVES KIT with:

- n°2 Valves with chrome tailpieces
- n°2 Fittings (multilayer \varnothing 16, copper \varnothing 12, 14)
- n°2 Chrome wall plates \varnothing 48, hole \varnothing 16

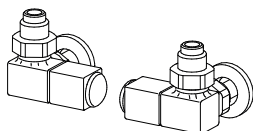

SIDE CONTROL QUADRA VALVES KIT
page 271 Art. KQL 191,20€
Extra for BREM color list 53,40€

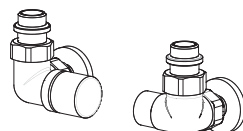

SIDE CONTROL CYL VALVES KIT with THERMO-
STATIC option, page 273 Art. KCL 162,50€
Extra for BREM color list 53,40€

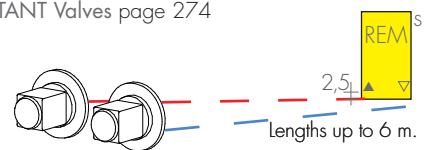

SPECIAL FINISHES page 267
Finishes Gold, Bronze, Brushed Nickel for 2 valves
Brushed Nickel FITTING KIT extra Art. RN 30,50€

REMOTE FITTINGS Art. REM 42,10€
Tapping centres: at the rear \blacktriangle \blacktriangledown EG L-5 cm
DISTANT Valves page 274

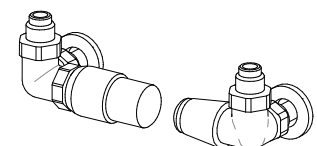

SIDE CONTROL TON VALVES KIT with THERMO-
STATIC Head, page 269 Art. KTL 203,70€