

# S-PLATT GILDED/SILVER LEAF

PRICE FROM 1.07.2022

**+15%**

The SP-PLATT radiating plate is available with other finishes in gilded leaf and silver

leaf with precious originality that creates unusual atmosphere.

In the order code, state the letter:  
O for gilded / A for silver leaf finish.

## DIMENSIONS

Length: from 28 to 84 cm

Heights: from 160 to 240 cm (every 20 cm)

Depths: SP..H 3,7 cm, SPL H 6,2 cm

Depths from wall: SP..H 6,8 cm, SPL H 7,8 cm

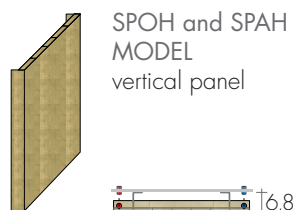

SPOH and SPAH  
MODEL  
vertical panel

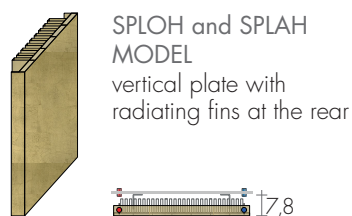

SPLOH and SPLAH  
MODEL  
vertical plate with  
radiating fins at the rear

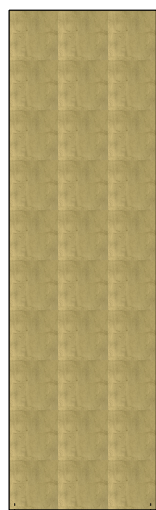

SP..H .. SPL..H ..



6,8

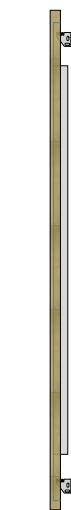

7,8

## TAPPING CENTRES

EG vertical fittings as standard  
Side fittings on request

Art. AS 75,50€

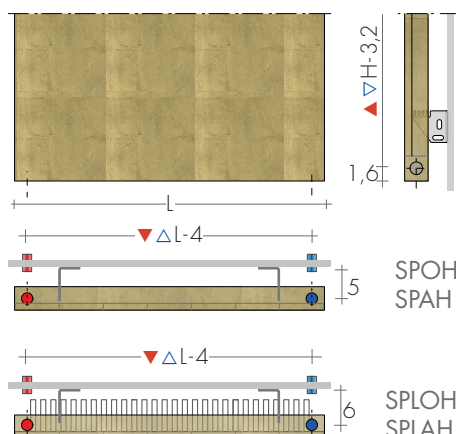

SPOH  
SPA

SPLOH  
SPLAH

Fixings and Valves page 111

EN 442 Watt  $\Delta t$  50K ( $\Delta t$  40K =  $W \times 0,755$ ) - ( $\Delta t$  30K =  $W \times 0,526$ )

MOD.	L cm	28	35	42	49	56	63	70	77	84
H cm	i.a. $\blacktriangle \nabla$ cm	24	31	38	45	52	59	66	73	80
SP..H 160	€	1441,90 420w	1541,60 525w	1644,20 630w	1747,90 735w	1849,40 840w	1950,20 945w	2053,60 1050w	2155,20 1155w	2257,80 1260w
SPL..H 160	€	1620,10 629w	1739,70 786w	1859,40 943w	1979,70 1100w	2101,30 1257w	2221,00 1414w	2342,40 1572w	2461,90 1729w	2582,70 1886w
SP..H 180	€	1478,70 467w	1584,00 584w	1688,50 701w	1795,80 817w	1902,30 934w	2006,60 1051w	2114,10 1168w	2219,50 1284w	2325,70 1401w
SPL..H 180	€	1660,80 689w	1783,20 861w	1898,30 1033w	2030,00 1205w	2153,30 1377w	2275,80 1549w	2399,30 1721w	2522,80 1893w	2644,30 2065w
SP..H 200	€	1512,60 513w	1621,20 642w	1731,10 770w	1836,70 898w	1945,90 1026w	2054,20 1155w	2162,40 1283w	2272,40 1411w	2380,80 1540w
SPL..H 200	€	1719,70 742w	1850,20 928w	1979,20 1113w	2115,80 1299w	2238,90 1484w	2368,20 1670w	2497,60 1855w	2625,70 2041w	2754,80 2226w
SP..H 220	€	1552,40 557w	1664,50 697w	1777,60 836w	1899,80 976w	2005,40 1115w	2118,60 1254w	2229,60 1394w	2344,60 1533w	2458,30 1673w
SPL..H 220	€	1754,30 802w	1888,20 1003w	2021,00 1204w	2161,50 1404w	2288,10 1605w	2420,70 1806w	2553,70 2006w	2685,40 2207w	2818,30 2407w
SP..H 240	€	1602,80 601w	1721,50 751w	1840,00 901w	1958,60 1051w	2077,40 1201w	2196,10 1351w	2314,60 1502w	2435,10 1652w	2554,90 1802w

O: GILDED leaf  
A: SILVER leaf

$\Delta t$  different from 50 K: consult Technical data Brem

## HOW TO ORDER

State: model (simple model or with fins),  
height, width and fittings

e.g.: SPLOH 180 - 35 EG 1/2" (gilded leaf)

## STANDARD PRODUCTION

Gilded/Silver leaf finish

BRO019 or BRO002 color painted brackets

Tolerance  $\pm$  3mm - Air vent  $\varnothing$  1/8"

## PRODUCTION ON REQUEST

Gilded/Silver leaf valves, page 275

Versions with SUIT dimensions, on request

## STANDARD FITTING

EG  $\varnothing$  1/2"

Fittings AC or BD with extra

Special fittings, page 286

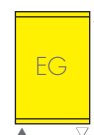

The S-PLATT panel: a minimalist, smooth and flat surface available in the simple horizontal version (SP..V) or in the version

with radiating fins at the rear (SPL..V). In the order code, state the letter: O for gilded / A for silver leaf finish.

SPXV MODEL  
Horizontal panel  
L from 50 to 200 cm

SPLXV MODEL  
Horizontal panel  
with fins at rear

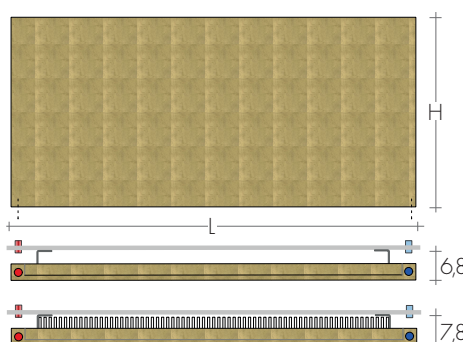
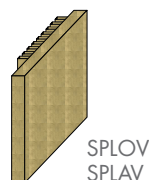
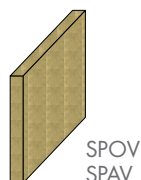

TAPPING CENTRES  
EG vertical fittings as standard  
Side fittings on request Art. AS 75,50€

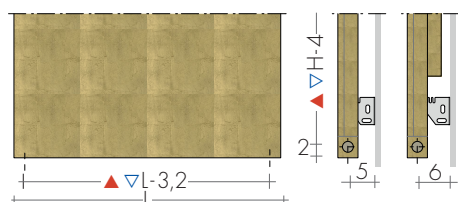

Fixings and Valves page 113



MOD.	L cm	50	60	70	80	90	100	120	140	160	180	200	220
H. cm	i.a.	46,8	56,8	66,8	76,8	86,8	96,8	116,8	136,8	156,8	176,8	196,8	216,8
SP..V 35	€	1012,00 178w	1067,50 213w	1122,90 249w	1174,50 284w	1228,80 320w	1291,60 355w	1401,00 426w	1511,60 497w	1618,60 568w	1663,20 639w	1702,40 710w	1747,90 781w
SPL..V 35/35	€	1296,00 367w	1367,00 440w	1438,20 513w	1504,20 586w	1573,90 660w	1654,20 733w	1794,50 880w	1936,10 1026w	2073,20 1173w	2130,00 1319w	2180,30 1466w	2238,60 1613w
SP..V 42	€	1080,30 217w	1136,10 260w	1195,80 304w	1256,60 347w	1316,30 391w	1380,60 434w	1489,90 521w	1614,30 608w	1726,60 694w	1772,90 781w	1817,60 868w	1866,40 955w
SPL..V 42/28	€	1364,40 380w	1435,10 456w	1510,80 532w	1587,30 608w	1662,90 684w	1744,10 760w	1882,10 912w	2039,40 1064w	2181,00 1216w	2239,80 1368w	2296,30 1520w	2357,90 1672w
SPL..V 42/42	€	1398,80 417w	1471,10 500w	1548,60 584w	1627,40 667w	1704,80 751w	1788,00 834w	1929,60 1001w	2090,70 1168w	2236,00 1334w	2296,10 1501w	2354,00 1668w	2417,10 1835w
SP..V 49	€	1121,30 246w	1190,00 295w	1253,90 344w	1315,50 394w	1380,60 443w	1444,60 492w	1574,00 590w	1702,50 689w	1835,40 787w	1885,50 886w	1928,50 984w	1994,80 1083w
SPL..V 49/28	€	1397,10 380w	1482,70 456w	1562,40 532w	1639,50 608w	1720,20 684w	1800,00 760w	1961,40 912w	2121,50 1064w	2286,90 1216w	2349,60 1368w	2403,10 1520w	2485,80 1672w
SPL..V 49/49	€	1430,70 466w	1518,30 559w	1599,90 652w	1678,70 745w	1761,70 838w	1843,20 931w	2008,40 1117w	2172,40 1303w	2341,80 1490w	2406,00 1676w	2460,70 1862w	2545,50 2048w
SP..V 56	€	1187,80 276w	1256,50 331w	1325,50 386w	1394,00 441w	1463,10 496w	1532,10 551w	1662,00 661w	1804,30 771w	1941,90 882w	1997,50 992w	2043,10 1102w	2105,70 1212w
SPL..V 56/28	€	1457,50 444w	1541,70 533w	1626,40 622w	1710,40 710w	1795,40 799w	1880,10 888w	2039,40 1066w	2213,90 1243w	2382,80 1421w	2451,10 1598w	2507,10 1776w	2584,00 1954w
SPL..V 56/56	€	1551,80 511w	1641,60 613w	1731,70 715w	1821,30 818w	1911,70 920w	2001,70 1022w	2171,40 1226w	2357,30 1431w	2536,90 1635w	2609,60 1840w	2669,50 2044w	2751,30 2249w
SP..V 63	€	1234,70 305w	1307,50 366w	1376,60 427w	1453,30 488w	1525,30 549w	1603,60 610w	1753,20 732w	1902,20 854w	2047,60 976w	2107,10 1098w	2156,80 1220w	2224,50 1342w
SPL..V 63/35	€	1496,20 501w	1584,30 601w	1668,20 701w	1761,10 801w	1848,30 901w	1943,20 1001w	2124,40 1201w	2304,90 1401w	2481,40 1602w	2553,40 1802w	2613,50 2002w	2695,60 2202w
SPL..V 63/63	€	1586,20 557w	1679,50 668w	1768,50 779w	1867,00 890w	1959,30 1002w	2060,10 1113w	2252,10 1336w	2443,70 1558w	2630,40 1781w	2706,70 2003w	2770,70 2226w	2857,60 2449w
SP..V 70	€	1283,00 326w	1363,50 391w	1437,50 456w	1520,30 521w	1597,40 586w	1674,70 651w	1831,80 781w	1989,20 911w	2156,30 1042w	2219,80 1172w	2270,50 1302w	2341,10 1432w
SPL..V 70/35	€	1530,70 532w	1626,90 638w	1715,10 744w	1813,80 850w	1905,90 957w	1998,30 1063w	2185,50 1276w	2373,40 1488w	2572,60 1701w	2648,30 1913w	2708,90 2126w	2793,30 2339w
SPL..V 70/70	€	1614,30 598w	1715,90 718w	1809,00 837w	1913,00 957w	2010,10 1076w	2107,50 1196w	2305,10 1435w	2503,10 1674w	2713,40 1914w	2793,30 2153w	2857,00 2392w	2945,90 2631w
SP..V 77	€	1355,70 365w	1445,30 437w	1520,60 510w	1607,70 583w	1689,20 656w	1774,00 729w	1935,80 875w	2098,40 1021w	2262,90 1166w	2330,50 1312w	2386,00 1458w	2461,80 1604w
SPL..V 77/35	€	1606,60 562w	1712,80 674w	1801,90 787w	1905,40 899w	2001,80 1012w	2102,50 1124w	2294,00 1349w	2486,90 1574w	2681,70 1798w	2761,80 2023w	2827,60 2248w	2917,40 2473w
SPL..V 77/70	€	1691,20 624w	1803,10 749w	1896,80 874w	2005,70 998w	2107,50 1123w	2213,30 1248w	2414,80 1498w	2617,80 1747w	2823,00 1997w	2907,40 2246w	2976,60 2496w	3071,20 2746w
SP..V 84	€	1405,70 394w	1497,80 472w	1584,60 551w	1666,20 630w	1755,30 708w	1844,60 787w	2021,30 944w	2191,70 1102w	2370,50 1259w	2442,10 1417w	2499,80 1574w	2581,40 1732w
SPL..V 84/35	€	1644,00 590w	1751,70 708w	1853,20 826w	1948,60 944w	2052,70 1062w	2157,30 1180w	2363,70 1416w	2563,10 1652w	2772,20 1888w	2856,10 2124w	2923,40 2360w	3018,80 2596w
SPL..V 84/70	€	1728,80 652w	1841,80 782w	1948,60 912w	2049,00 1042w	2158,50 1173w	2268,50 1303w	2485,40 1564w	2695,20 1824w	2914,90 2085w	3003,30 2345w	3074,10 2606w	3174,30 2867w

eg.: SPLOV 49/28-180, EG ø1/2"

Lengths every 10 cm: thermal output and prices obtained by interpolation