

The START heated towel rail is produced using thin radiating $\varnothing 12$ tubes connected to vertical manifolds forming the exclusive

pointed arch shape. The straight version is unusual in that it has offset upper tubes to improve the distribution of the heat.

The valves are positioned on the inside, to produce a clean design, reducing the total space taken up by the towel rail.

DIMENSIONS

Width 35 / 45 / 55 / 60 / 70 cm
 Height 75 / 90 / 120 / 150 / 180 cm
 Depth 4,7 cm
 Depth from wall 10 cm

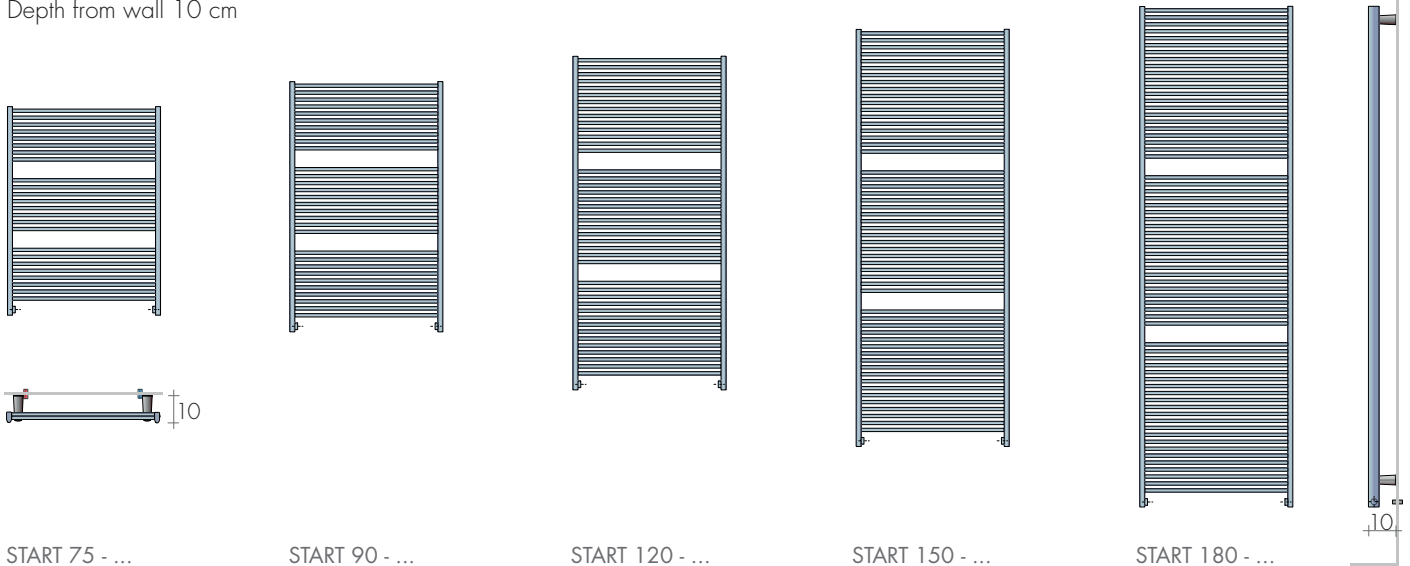

MODEL	HL cm	white sablé standard €	EN 442		▲ ▽ t.c. cm	Height H cm	Width L cm	Weight M Kg	Volume V dm ³	MIXED Version (EHE cl.II) with sleeve and: cable ^o digital thermostat		
			Δt 50 K watt	Δt 30 K watt						€	W	€
START	75-45	346,60	339	174	31	75	45	4,4	1,46	108,80	250	171,10
START	75-55	363,00	401	206	41	75	55	5,0	1,65	110,80	400	173,10
START	90-45	423,80	409	210	31	90	45	5,4	1,79	110,80	400	173,10
START	90-55	441,80	484	249	41	90	55	6,2	2,03	112,70	500	175,00
START	90-60	451,50	522	268	46	90	60	6,6	2,15	112,70	500	175,00
START	120-45	506,80	552	284	31	120	45	7,4	2,46	112,70	500	175,00
START	120-55	525,10	654	336	41	120	55	8,6	2,79	114,60	650	176,90
START	120-60	533,60	706	363	46	120	60	9,1	2,95	114,60	650	176,90
Slim START	150-35	615,10	573	295	21	150	35	7,1	2,43	112,70	500	175,00
START	150-45	633,00	703	361	31	150	45	9,4	3,12	114,60	650	176,90
START	150-55	660,10	832	428	41	150	55	10,9	3,54	118,80	800	181,10
START	150-60	674,20	896	461	46	150	60	11,6	3,76	121,90	900	184,20
Slim START	180-35	707,80	706	363	21	180	35	9,6	2,94	114,60	650	176,90
START	180-45	725,90	861	443	31	180	45	11,5	3,78	121,90	900	184,20
START	180-55	752,90	1016	522	41	180	55	13,3	4,30	121,90	900	184,20
START	180-60	771,20	1094	562	46	180	60	14,2	4,56	129,20	1200	191,50
START	180-70	806,40	1249	642	56	180	70	15,9	5,08	129,20	1200	191,50
CHROME-PLATED VERSION												
ST-CROM	90-45	943,90	327	168	31	90	45	5,4	1,79	108,80	250	171,10
ST-CROM	120-45	1127,70	442	227	31	120	45	7,4	2,46	110,80	400	173,10
ST-CROM	120-55	1168,40	523	269	41	120	55	8,6	2,79	112,70	500	175,00
ST-CROM	150-35	1368,60	458	236	21	150	35	7,1	2,43	112,70	500	175,00
ST-CROM	150-45	1409,40	562	289	31	150	45	9,4	3,12	112,70	500	175,00
ST-CROM	150-55	1470,90	666	343	41	150	55	10,9	3,54	114,60	650	176,90
ST-CROM	180-35	1575,70	565	291	21	180	35	9,6	2,94	112,70	500	175,00
ST-CROM	180-55	1677,30	813	418	41	180	55	13,3	4,30	121,90	900	184,20

Made-to-measure versions on request

Ready Stock

Δt 40K = Watt Δt 50K x 0,755

^oRadio frequency chronothermostat p.277

STANDARD PRODUCTION

White "sablé" paintwork - Brackets M8B
 Chrome-plated finish with chrome brackets
 Tolerance ± 3 mm - Air vent $\varnothing 1/8"$
 Maximum operating pressure 8 bar

PRODUCTION ON REQUEST

Paint to Brem color list +15/25%
 Start DIVIS, page 234
 Electric version e.Start page 267

STANDARD FITTING

REG $\varnothing 1/2"$
 EG and side fittings, on request
 Brem reverse valves page 273

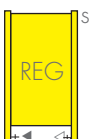

TAPPING CENTRES REG

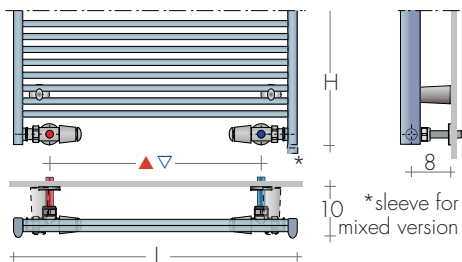

ON REQUEST
EG fittings

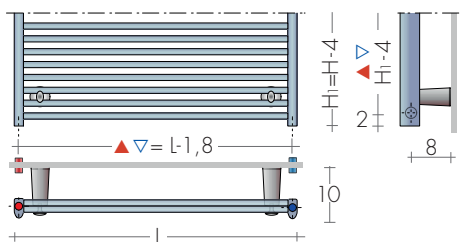

Height is 4 cm less (H1) for:
 - EG fitting (t.c. L-1,8cm) Art. AS 75,50€
 - side fittings (t.c. H1-4cm) Art. AS 75,50€

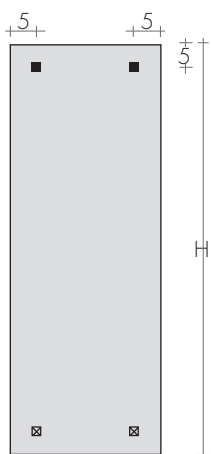

FIXINGS
Brackets included



Art. M8..

☒ START H 180 cm



START 180-45

RECOMMENDED VALVES

CHROME PLATED VALVES KIT WITH:

- n°2 Valves with O-ring Tangs
- n°2 Fittings (multilayer ø16, copper ø12,14)
- n°2 Round washers

On request: Polished stainless tube cover
 (to be cut to right size) Art. CA18 10,80€

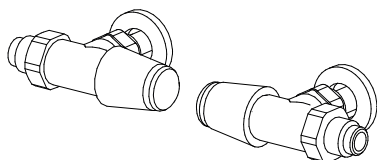

REVERSE TON VALVES KIT
page 277

Art. KVR 119,20€

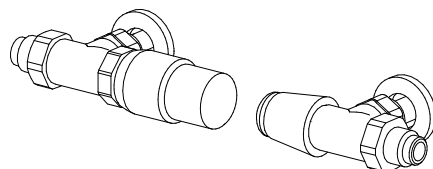

REVERSE TON VALVES KIT with
THERMOSTATIC head Art. KTR 165,50€

REMOTE FITTINGS Art.REM 36,60€
 remote fittings at the rear (EG tapping centres)



REMOTE VALVES ASSEMBLY KIT p. 281 with:
 - n°2 Fittings (multilayer ø16, copper ø12,14)

REMOTE TON VALVES ASSEMBLY KIT
 Art. KVG 153,60€

REMOTE TON VALVES ASSEMBLY KIT with
 THERMOSTATIC head Art. KVGt 199,80€